



## A. Sketch.

- Step 1. Click File Menu > New, click **Part** and OK.
- Step 2. Click **Top Plane**  in the Feature Manager and click **Sketch**  from the Content toolbar, **Fig. 1**.

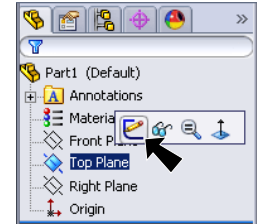

**Fig. 1**

- Step 3. Click **Circle**  (S) on the Sketch toolbar.

- Step 4. Draw a circle starting at the Origin , **Fig. 2**.

- Step 5. Click **Smart Dimension**  (S) on the Sketch toolbar.

- Step 6. Dimension circle **diameter .5**, **Fig. 2**.

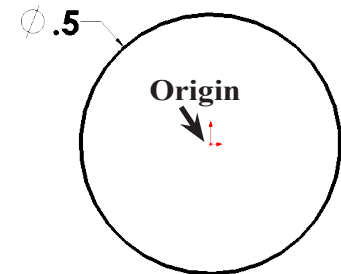

**Fig. 2**

- Step 7. Click Zoom to Fit  (F) on the View toolbar.

## B. Save as "ROD".

- Step 1. Click File Menu > Save As.
- Step 2. Key-in **ROD** for filename and press ENTER.

## C. Extrude.

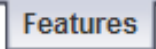
- Step 1. Click **Features**  on the Command Manager toolbar.

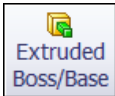
- Step 2. Click **Extruded Boss/Base**  on the Features toolbar.

- Step 3. In the Property Manager set:  
under Direction 1, **Fig. 3**

**Depth**  **D1** **5.2**  
click OK .

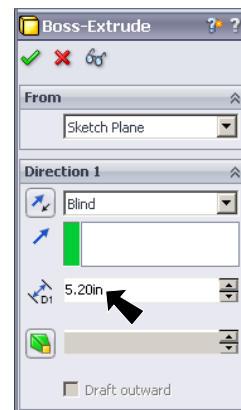

**Fig. 3**

- Step 4. Save. Use **Ctrl-S**.



**Fig. 4**

## D. Chamfers.

Step 1. Click **Chamfer**  in the **Fillet flyout**  on the **Features** toolbar.

Step 2. In the Chamfer Property Manager set:

**Depth**  **.05**, Fig. 55

**Angle**  **45°**

select **Full preview**

click **top edge**, Fig. 6

click **OK** .

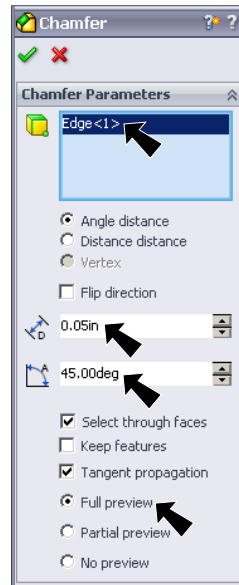

Fig. 5

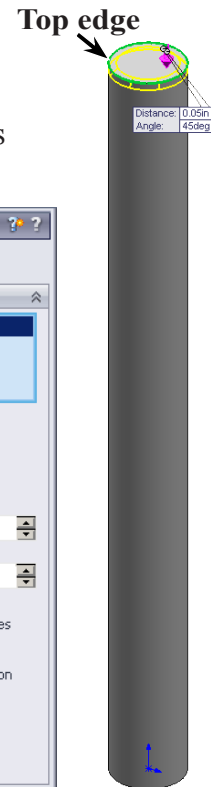

Fig. 6



Fig. 7

## E. Material Steel.

Step 1. **Right click Material**  in the **Feature Manager** and click **Edit Material**, Fig. 8.

Step 2. **Expand Steel** in the material tree and select **Plain Carbon Steel**. Click **Apply** and **Close**.

Step 3. Save. Use **Ctrl-S**.

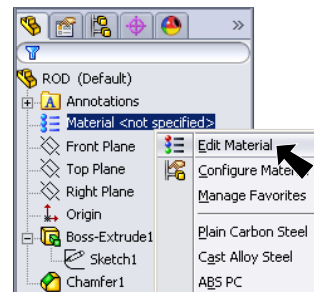

Fig. 8

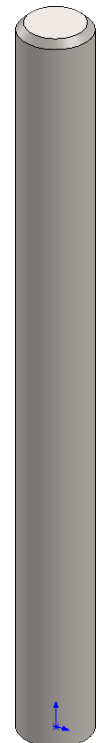

Fig. 9