

Airplane V Stab

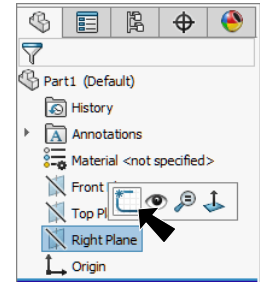
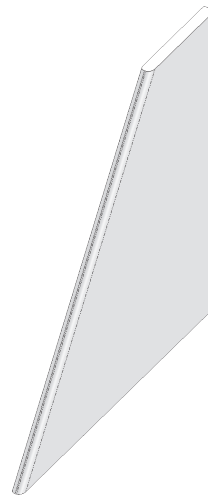

Fig. 1

A. Sketch.

- Step 1. Click File Menu > New, click **Part** and OK.
- Step 2. Click **Right Plane** in the Feature Manager and click **Sketch** on the context toolbar, **Fig. 1**.
- Step 3. Click **Line** (L) on the Sketch toolbar.

- Step 4. Starting at the Origin sketch the V stab. Keep **top and bottom lines horizontal** and **right side vertical**, **Fig. 2**.

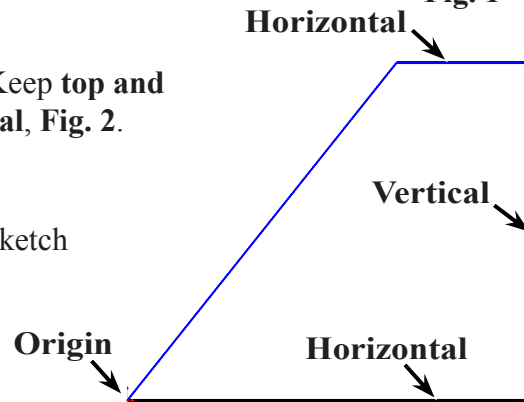

Fig. 2

- Step 5. Click **Smart Dimension** (S) on the Sketch toolbar.

- Step 6. Add dimensions, **Fig. 3**.

B. Extrude.

- Step 1. Click **Features** on the Command Manager toolbar.

- Step 2. Click **Extruded Boss/Base** on the Features toolbar.

- Step 3. In the Boss-Extrude Property Manager set:
under Direction 1, **Fig. 5**
End Condition **Mid Plane**

Depth .1
click OK

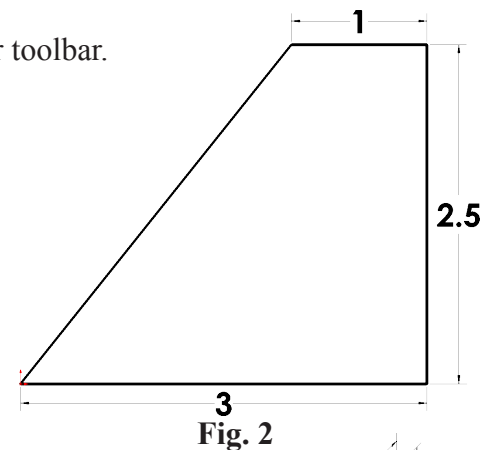

Fig. 2

C. Save as "V STAB".

- Step 1. Click File Menu > Save As.
- Step 2. Key-in **V STAB** for filename and press ENTER.

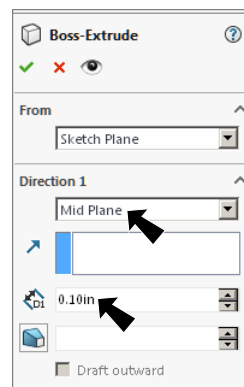

Fig. 4

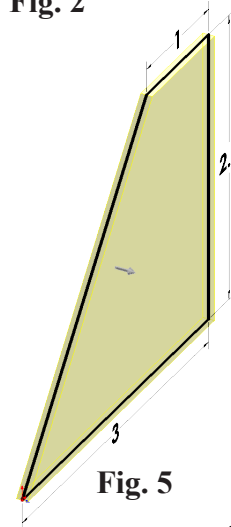



Fig. 5

D. Fillet Leading Edge.

Step 1. Click **Fillet**  on the Features toolbar.

Step 2. In the Fillet Property Manager set:
select **FilletXpert**, **Fig. 6**

Radius  **.045**
click the **two**
edges of the
leading edge,
Fig. 7
click OK .

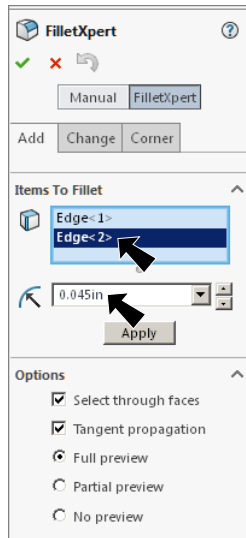

Fig. 6

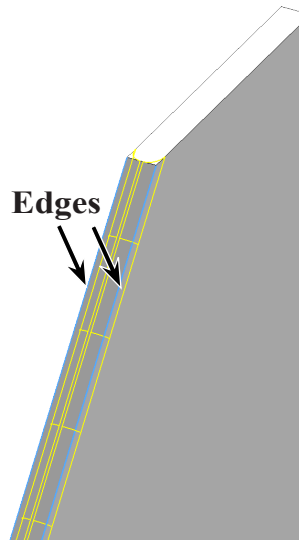

Fig. 7

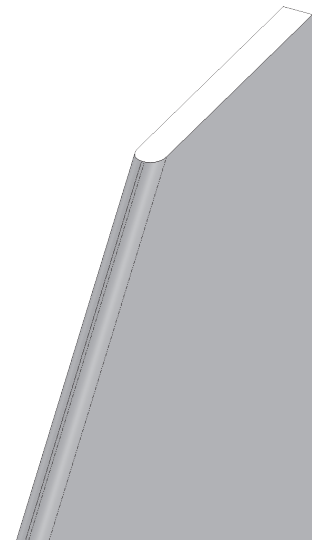

Fig. 8

E. Material PS HI (Polystyrene).

Step 1. **Right click Material**  in the Feature Manager and click **Edit Material**.

Step 2. **Expand Plastics** in the material tree and select **PS HI**. Click **Apply** and **Close**.

Step 3. Save. Use **Ctrl-S**.

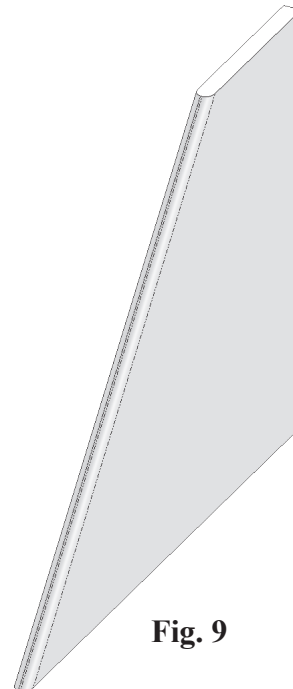

Fig. 9