



A. Corner Rectangles.

Step 1. Click File Menu > New, click **Part** and OK.

Step 2. Click **Front Plane**  in the Feature Manager and click **Sketch**  on the context toolbar, **Fig. 1**.

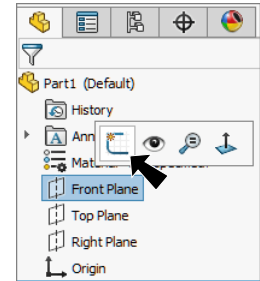

Fig. 1

Step 3. Click **Corner Rectangle**  in the **Rectangle flyout**  on the Sketch toolbar.

Step 4. Sketch a corner rectangle away from the Origin , **Fig. 2**.



Fig. 2

Step 5. **Right click graphics area and click Select** from menu to unselect Rectangle tool.

Step 6. **Ctrl click line bottom line of rectangle and Origin** to select both. Release Ctrl key and click **Make Midpoint**  on the context toolbar, **Fig. 3**.

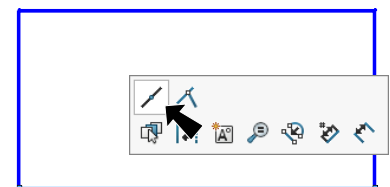

Ctrl click line and Origin
Fig. 3

Step 7. Click **Smart Dimension**  (S) on the Sketch toolbar.

Step 8. Dimension rectangle .4 by .2, **Fig. 4**.

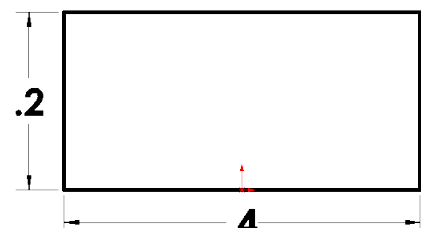

Fig. 4

Step 9. Click Zoom to Fit  (F) on the View toolbar.

Step 10. Click **Corner Rectangle**  in the **Rectangle flyout**  on the Sketch toolbar.

Step 11. Sketch a corner rectangle inside first rectangle, **Fig. 5**.

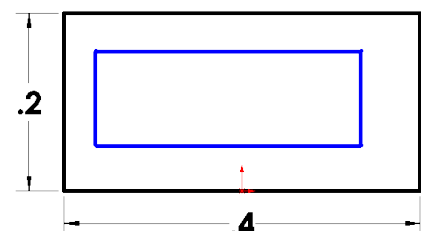
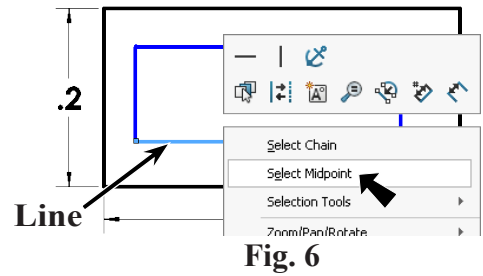



Fig. 5

Step 12. **Right click graphics area and click Select** from menu to unselect Rectangle tool.

Step 13. **Right click bottom line of second rectangle** and click **Select Midpoint** on the context toolbar, **Fig. 6**.



Step 14. **Ctrl click Origin**  to select midpoint and Origin, **Fig. 7**. Release Ctrl key and click **Make Vertical**  on the context toolbar.

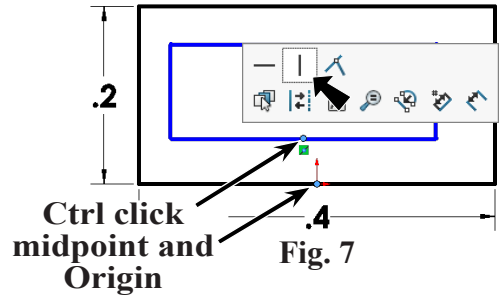

Step 15. Click **Smart Dimension**  (S) on the Sketch toolbar.

Step 16. Dimension inside rectangle **.3** by **.15**, **Fig. 8**.

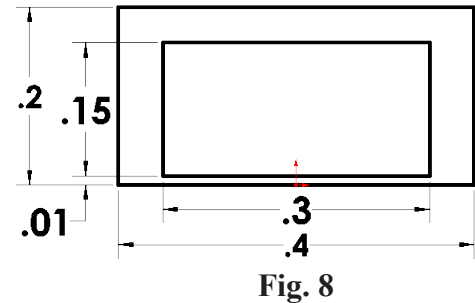



Step 17. Click **Features**  on the Command Manager toolbar.

Step 18. Click **Extruded Boss/Base**  on the Features toolbar.

Step 19. In the Boss-Extrude Property Manager set:
under Direction 1, **Fig. 9**
End Condition **Mid Plane**

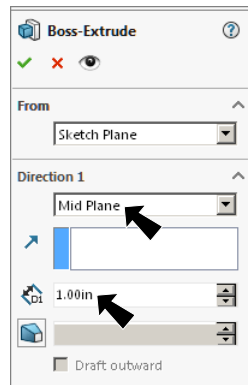
Depth  **1**
click OK .



Step 20. Click **Zoom to Fit**  (F) on the View toolbar.

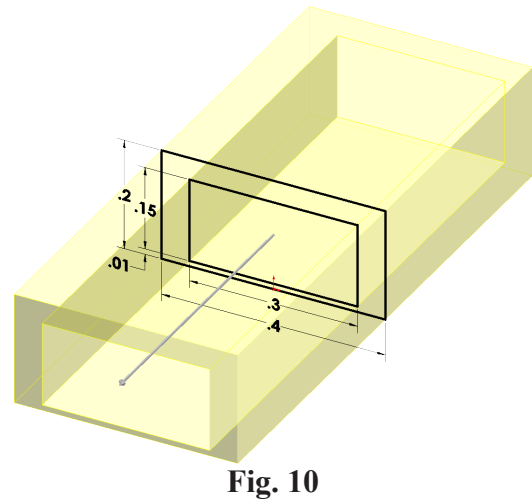

B. Save as "FRAME".

Step 1. Click File Menu > Save As.

Step 2. Key-in **FRAME** for the filename and press ENTER.

C. Fillet.

Step 1. Click **Fillet**  on the Features toolbar.

Step 2. In the Fillet Property Manager set:
select **FilletXpert**, **Fig. 11**

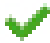
Radius  **.05**
click **both top edges**, **Fig. 12**
click **OK** .

Step 3. Save. Use **Ctrl-S**.

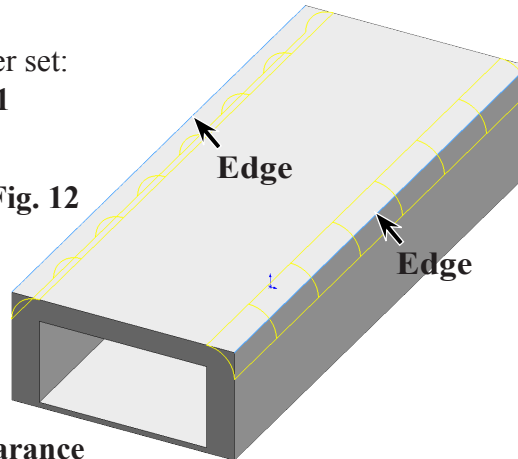

Fig. 12

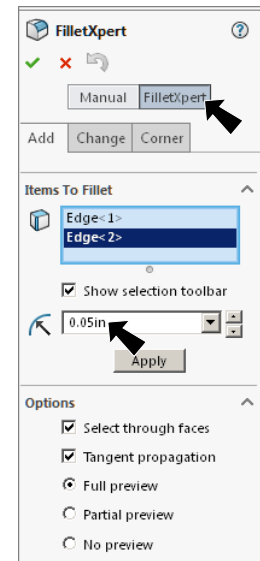

Fig. 11

D. Appearance Color.

Step 1. Click the Part, expand **Appearance**

Callout  on the context toolbar and click **FRAME** , **Fig. 13**.

Step 2. In the Appearances Property Manager:

under **Color**, **Fig. 14**
set **RGB values**:
R 95
G 154
B 255

click **OK** .

Step 3. Save. Use **Ctrl-S**.

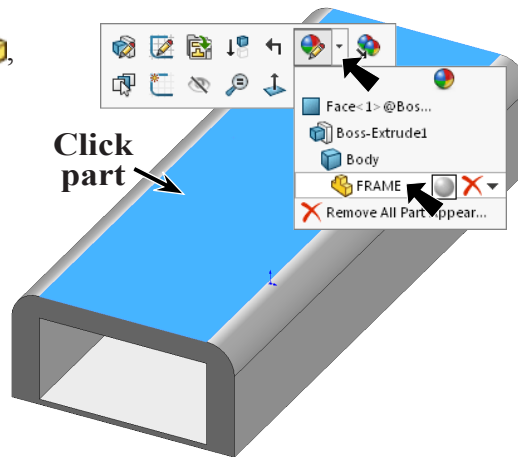

Fig. 13

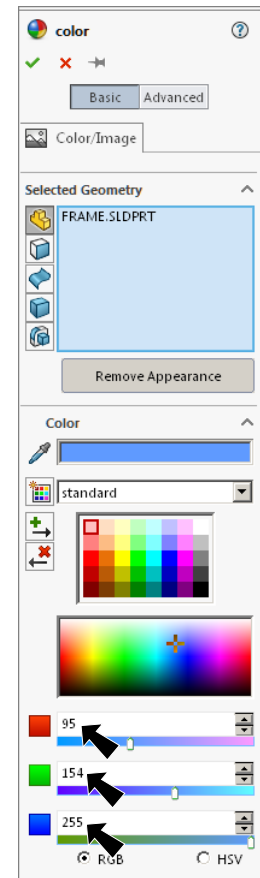

Fig. 14

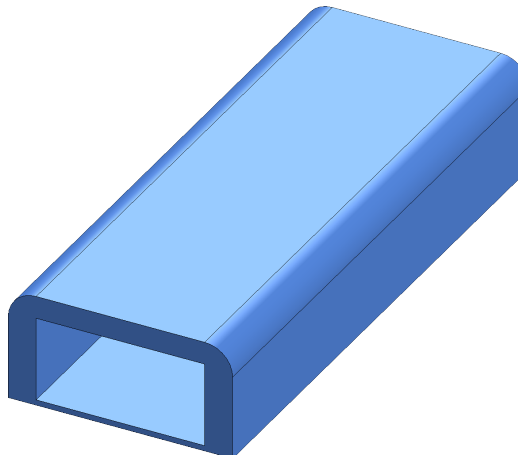

Fig. 15