

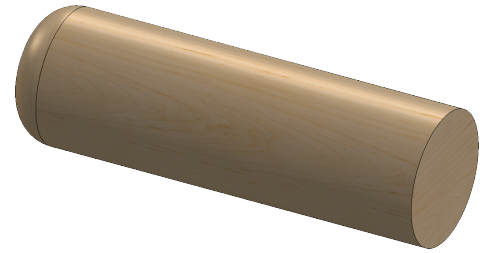



Chapter 3

Penny Hockey Dowel Pin



A. Dowel Pin.

Step 1. Click File Menu > New, click **Part** and OK.

Step 2. Click **Right Plane**  in the Feature Manager and click **Sketch**  from the Content toolbar, **Fig. 1**.

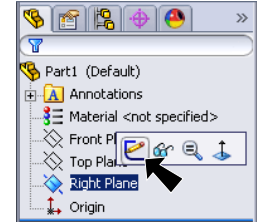

Fig. 1

Step 3. Click **Circle**  (S) on the Sketch toolbar.

Step 4. Draw a circle starting at the Origin , **Fig. 2**.

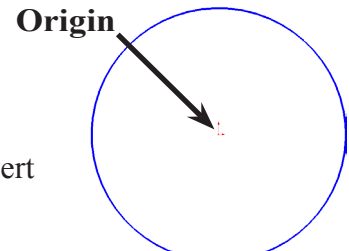

Fig. 2

Step 5. Click **Smart Dimension**  (S) on the Sketch toolbar.

Step 6. Dimension circle **diameter 3/8**, **Fig. 3**. The dimension will convert to decimal .38.

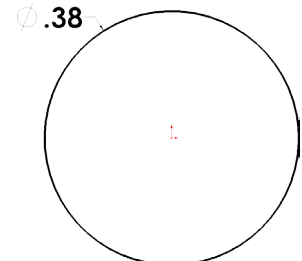
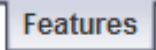
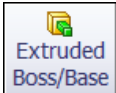

Fig. 3

Step 7. Click **Features**  on the Command Manager toolbar.

Step 8. Click **Extruded Boss/Base**  on the Features toolbar.

Step 9. In the Property Manager set: under Direction 1, **Fig. 4**

Depth  **D1 1.2**

click **OK** , **Fig. 5**.

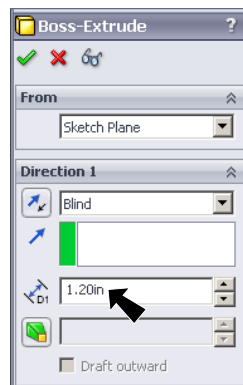



Fig. 4

Step 10. Click **Zoom to Fit**  (F) on the View toolbar.

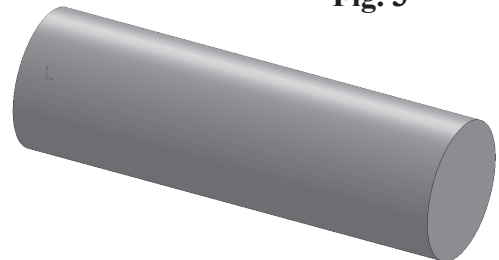

Fig. 5

B. Save as "DOWEL PIN".

Step 1. Click File Menu > Save As.

Step 2. Key-in **DOWEL PIN** for the filename and press ENTER.

C. Fillet.

Step 1. Click **Fillet**  on the Features toolbar.

Step 2. In the Fillet Property Manager:
select **FilletXpert**, Fig. 6

Radius  **.06**
select **Full preview**

click **left edge**, Fig. 7

click **OK** .

Step 3. Save. Use **Ctrl-S**.

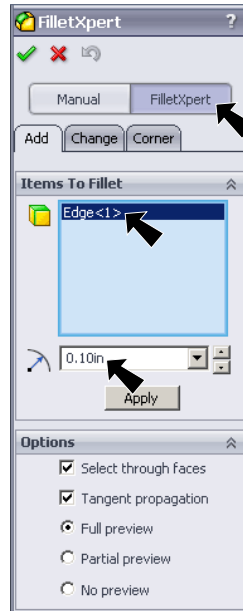

Fig. 6

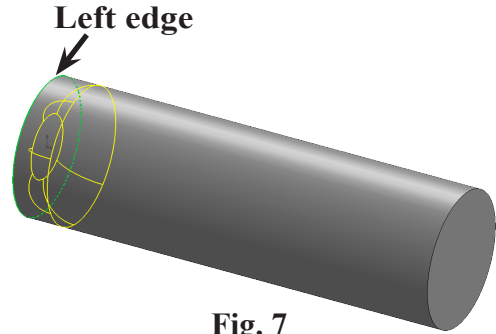

Fig. 7

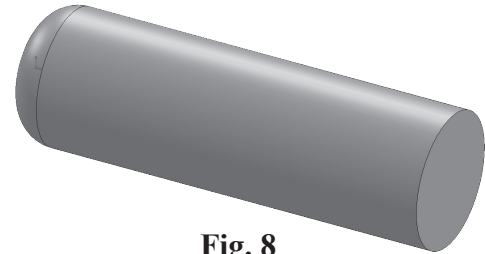



Fig. 8

D. Material Maple.

Step 1. **Right click Material**  in the Feature Manager and click **Edit Material** , Fig. 9.

Step 2. **Expand Woods** in the material tree and click **Maple**. Click **Apply** and **Close**, Fig. 10.

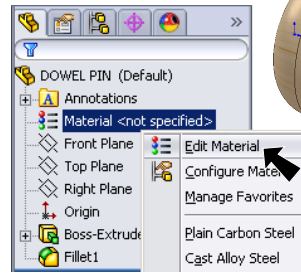

Fig. 9



Fig. 10

E. Rotate Mapping.

Step 1. Click PhotoView 360 Menu > **Edit Appearance**.

Step 2. In Appearances:

click **Mapping tab** , Fig. 11

Rotation 90

click **OK** , Fig. 12.

Step 3. Save. Use **Ctrl-S**.

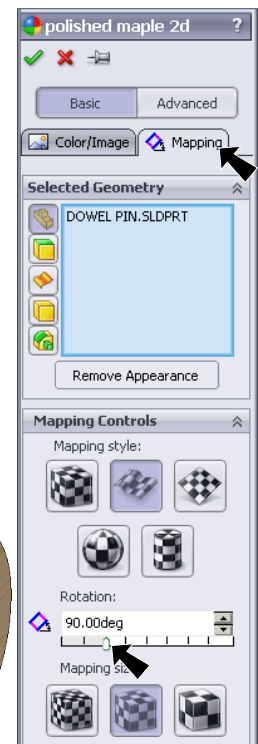

Fig. 11

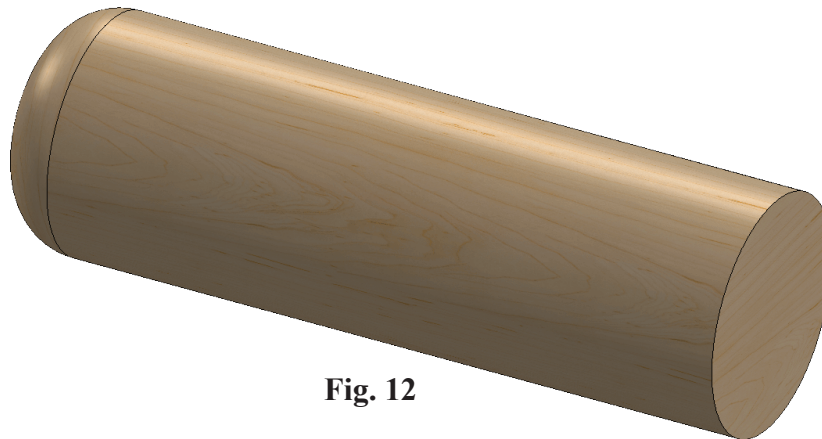

Fig. 12