

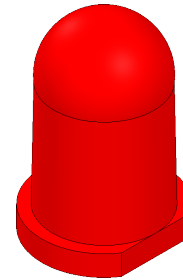



## HAWT LED Diode



### A. Extrude1.

Step 1. Click File Menu > New, click **Part Metric** and OK.

Step 2. Click **Top Plane**  in the Feature Manager and click **Sketch**  on the context toolbar, **Fig. 1**.

Step 3. Click **Circle**  (S) on the Sketch toolbar.

Step 4. Sketch **two circles** at Origin , **Fig. 2**.

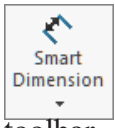
Step 5. Click **Smart Dimension**  (S) on the Sketch toolbar.

Step 6. Dimension **diameters 5 and 6**, **Fig. 3**.

Step 7. Click **Line**  (L) on the Sketch toolbar.

Step 8. Sketch **line vertical line across outside circle**, **Fig. 4**.

Step 9. **Unselect Line tool.** To unselect, **right click graphics area and click Select**  from menu.

Step 10. **Ctrl click vertical line and**

**inside circle** to select both. Release Ctrl key and click **Make Tangent**  on the context toolbar, **Fig. 5**.

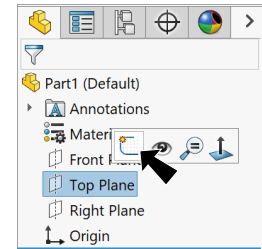

Fig. 1

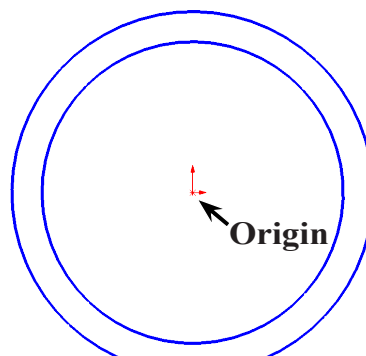

Fig. 2

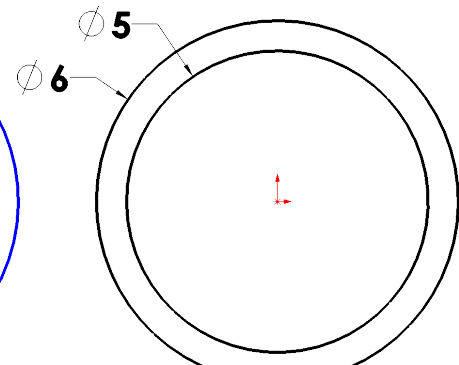

Fig. 3

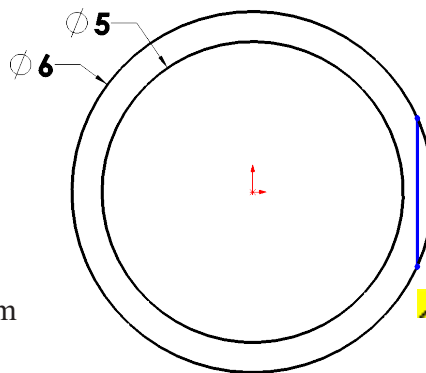

Fig. 4

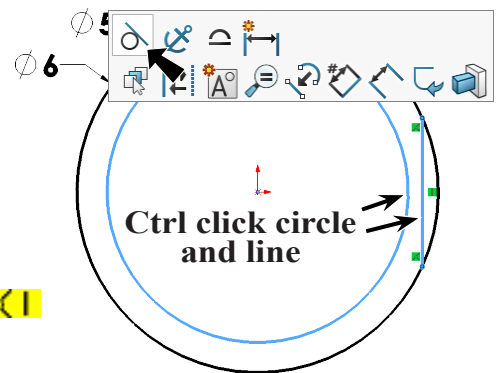

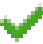

Fig. 5

Step 11. Click **Features**  on the Command Manager toolbar.

Step 12. Click **Extruded Boss/Base**  on the Features toolbar.

Step 13. In the Boss-Extrude Property Manager set:

- under Direction 1, **Fig. 6**
- End Condition **Blind**
- Depth  **1**
- under Selected Contours
- click the **two contours**, **Fig. 7**
- click OK .

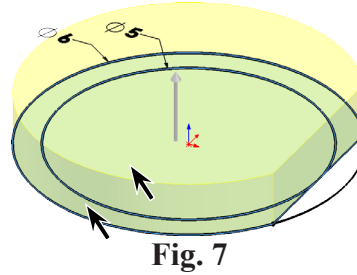

Fig. 7

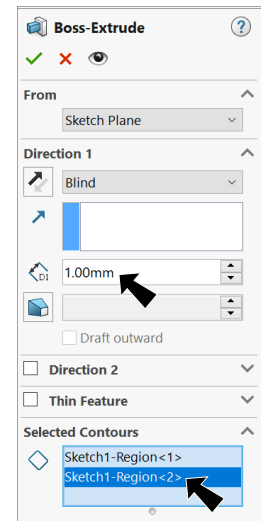

Fig. 6

## B. Save as "LED DIODE".

Step 1. Click File Menu > Save As.

Step 2. Key-in **LED DIODE** for the filename and press ENTER.

## C. Extrude2.

Step 1. Click the **top face** and click **Sketch**



on the context toolbar, **Fig. 8**.

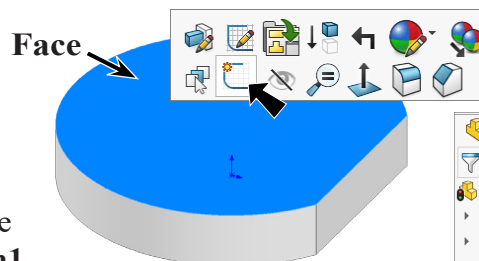

Fig. 8

Step 2. Expand **Boss-Extrude1** in the Feature Manager and click rail sketch, **Sketch1** to select sketch, **Fig. 9**.

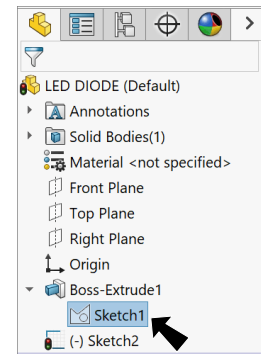

Fig. 9

Step 3. Click **Convert Entities**  on the Sketch toolbar, **Fig. 10**.

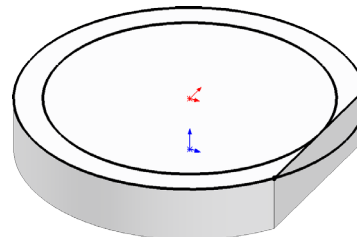
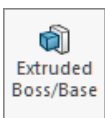





Fig. 10

Step 4. Click **Features**  on the Command Manager toolbar.

Step 5. Click **Extruded Boss/Base**  on the Features toolbar.

Step 6. In the Boss-Extrude Property Manager set:

- under Direction 1, **Fig. 11**
- Depth  **5.1**
- click **Draft**  **1°**
- under Selected Contours
- click **region inside small circle**,
- Fig. 12**
- click OK .

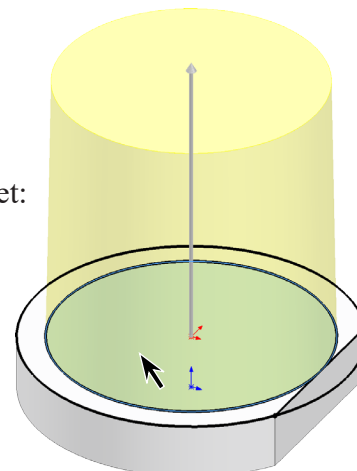

Fig. 12

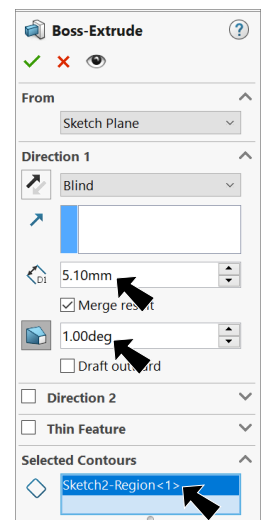



Fig. 11

## D. Dome.

Step 1. Click **Dome**  on the Features toolbar.

Step 2. In the Dome Property Manager set:  
 under Parameters, **Fig. 13**  
 click **top face**, **Fig. 14**  
**Distance 2.7**  
 click OK .

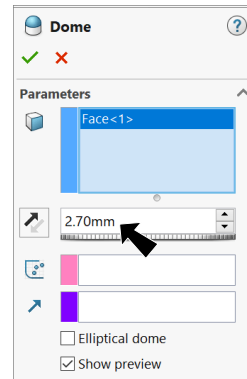

Fig. 13

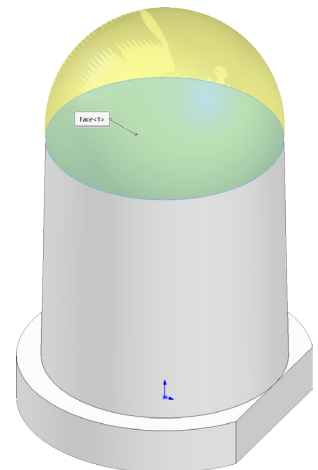

Fig. 14

## E. Appearance.

Step 1. Click the LED Diode to select part, click **Appearances Callout**



on the context toolbar and click **LED DIODE** , **Fig. 15**.

Step 2. In the Appearances Task pane, expand **Lights**, click **LED** and in the lower pane select **Red LED**, **Fig. 16**.

Step 3. In the Appearances Property Manager:

click **Advanced**

click **Illumination tab** , **Fig. 17**

under Illumination

**Luminous intensity 0**

click OK .

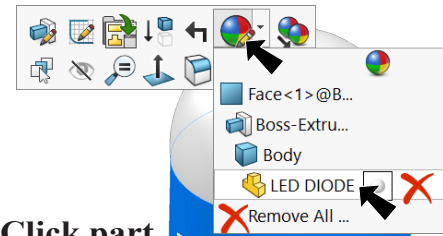

Click part 

Step 4. Save  (**Ctrl-S**).

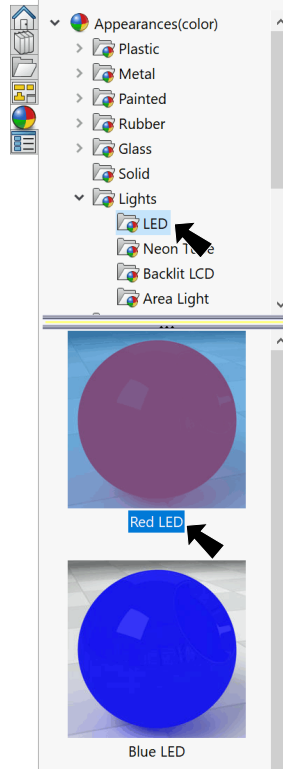

Fig. 16

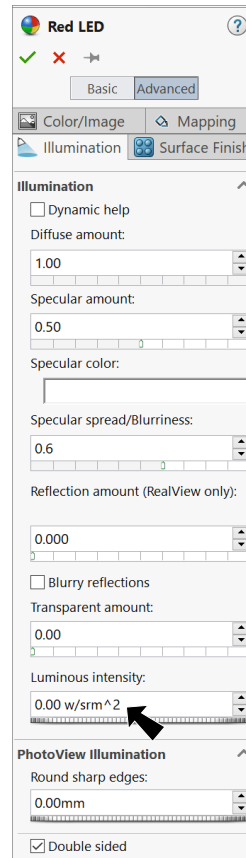

Fig. 17

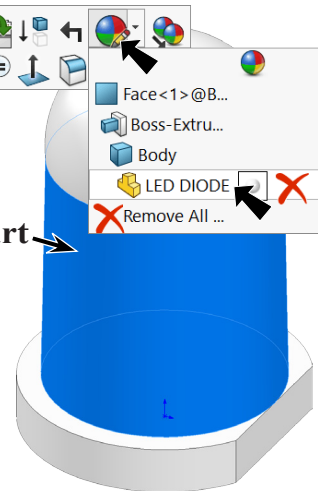

Fig. 15

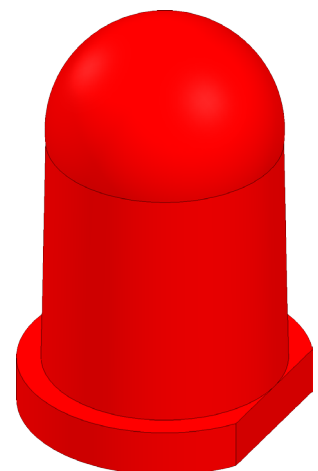

Fig. 18