

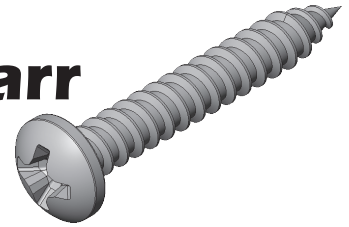

Chapter 12

HAWT

Screw from McMaster-Carr



A. McMaster-Carr website.

Step 1. Go to [McMaster-Carr](#) web page 18-8 Stainless Steel Phillips Rounded Head Screws for Sheet Metal .

Step 2. Click part number **92470A113**
No. 4 3/4"
set file type to **3-D SOLIDWORKS**
click **Download**, Fig. 1.

B. Copy Screw File.

Step 1. Use File Explorer (**Windows-E**) to copy the screw file from your Downloads folder to your **Wind Turbine folder**, Fig. 2.

The mates for the screw are in next chapter, the Assembly Chapter 13.

McMASTER-CARR screws

18-8 Stainless Steel Phillips Rounded Head Screws for Sheet Metal
metal. Length is measured from under the head.
Black-oxide stainless steel screws have a dark surface color.
CAD For technical drawings and 3-D models, click on a part number.

18-8 Stainless Steel—Inch						
Head						
Lg.	Dia.	Ht.	Drive Size	Drill Bit Size	Approximate Threads per Inch	Pkg. Qty.
No. 0						
1/8"	0.116"	0.044"	No. 0	No. 55	52	50 92470A015 \$6.86
3/16"	0.116"	0.044"	No. 0	No. 55	52	50 92470A018 6.93
1/4"	0.116"	0.044"	No. 0	No. 55	52	10 92470A022 7.42
5/16"	0.116"	0.044"	No. 0	No. 55	52	50 92470A024 7.17
3/8"	0.116"	0.044"	No. 0	No. 55	52	10 92470A026 7.59
7/16"	0.116"	0.044"	No. 0	No. 55	52	50 92470A028 7.36
1/2"	0.116"	0.044"	No. 0	No. 55	52	10 92470A031 7.78
5/8"	0.116"	0.044"	No. 0	No. 55	52	50 92470A041 9.36
3/4"	0.116"	0.044"	No. 0	No. 55	52	50 92470A045 10.79
No. 1						
1/8"	0.142"	0.053"	No. 0	No. 52	48	50 92470A048 6.61
3/16"	0.142"	0.053"	No. 0	No. 52	48	50 92470A049 6.50
1/4"	0.142"	0.053"	No. 0	No. 52	48	10 92470A050 7.08
5/16"	0.142"	0.053"	No. 0	No. 52	48	50 92470A055 6.86
3/8"	0.142"	0.053"	No. 0	No. 52	48	10 92470A054 7.29
7/16"	0.142"	0.053"	No. 0	No. 52	48	50 92470A056 7.05
1/2"	0.142"	0.053"	No. 0	No. 52	48	10 92470A057 7.50
5/8"	0.142"	0.053"	No. 0	No. 52	48	50 92470A061 7.38
3/4"	0.142"	0.053"	No. 0	No. 52	48	50 92470A065 9.21
No. 2						
1/8"	0.167"	0.062"	No. 1	No. 48	32	50 92470A089 7.71
3/16"	0.167"	0.062"	No. 1	No. 48	32	50 92470A091 6.39
1/4"	0.167"	0.062"	No. 1	No. 48	32	100 92470A095 4.40
5/16"	0.167"	0.062"	No. 1	No. 48	32	100 92470A099 3.86
3/8"	0.167"	0.062"	No. 1	No. 48	32	100 92470A097 4.97
7/16"	0.167"	0.062"	No. 1	No. 48	32	100 92470A102 4.19
1/2"	0.167"	0.062"	No. 1	No. 48	32	100 92470A098 5.58
5/8"	0.167"	0.062"	No. 1	No. 48	32	100 92470A101 6.25
3/4"	0.167"	0.062"	No. 1	No. 48	32	100 92470A103 6.62
No. 4						
3/16"	0.219"	0.08"	No. 1	No. 44	24	100 92470A106 4.76
1/4"	0.219"	0.08"	No. 1	No. 44	24	100 92470A107 4.57
5/16"	0.219"	0.08"	No. 1	No. 44	24	100 92470A109 4.81
3/8"	0.219"	0.08"	No. 1	No. 44	24	100 92470A108 5.03
7/16"	0.219"	0.08"	No. 1	No. 44	24	100 92470A111 5.10
1/2"	0.219"	0.08"	No. 1	No. 44	24	100 92470A110 6.61
5/8"	0.219"	0.08"	No. 1	No. 44	24	100 92470A112 7.20
3/4"	0.219"	0.08"	No. 1	No. 44	24	100 92470A113 7.80

Phillips Rounded Head Screws for Sheet Metal, 18-8 Stainless Steel, Number 4 Size, 3/4" Long

Packs of 100

ADD TO ORDER

Delivers Monday

Product Detail CAD 3-D Solidworks Download

Fig. 1

C:\Tech Ed 22-23\Wind Turbine

File Home Share View

Clipboard: Pin to Quick access, Copy, Paste, Copy path, Paste shortcut

Organize: Move to, Copy to, Delete, Rename

New: New folder, Easy access

Open: Properties, Edit, History, Invert selection

Select: Select all, Select none

This PC > Documents > Tech Ed 22-23 > Wind Turbine

- Tech Ed 11-12
- Tech Ed 12-13
- Tech Ed 13-14
- Tech Ed 14-15
- Tech Ed 15-16
- Tech Ed 16-17
- Tech Ed 17-18
- Tech Ed 18-19
- Tech Ed 19-20
- Tech Ed 20-21
- Tech Ed 21-22
- Tech Ed 22-23
- Wind Turbine**
- Tutorials

92470A113_Phillips Rounded Head Screws for Sheet Metal.SLDPR

BEARING 0030-10.SLDPR

BOTTOM NACELLE.SLDPR

GEAR 10T.SLDPR

GEAR 80T.SLDPR

LED DIODE.SLDPR

MOTOR.SLDPR

MULTIBODY NACELLE.SLDPR

SHAFT.SLDPR

TOP NACELLE.SLDPR

WIND TURBINE ASSEMBLY.SLDASM

Fig. 2