

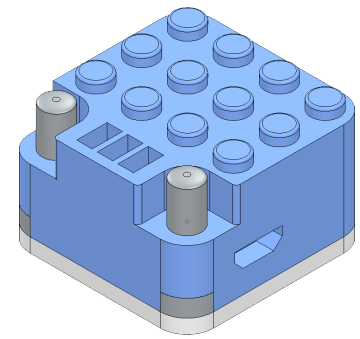

Battery Assembly



A. Insert Battery and Terminal.

Step 1. Click **New**  on the Standard toolbar, click **Assembly Metric**  and OK.

Step 2. Select your **BATTERY** file and click Open from the Open dialog box.

Step 3. In the Begin Assembly Property Manager set:

click **Keep Visible** , **Fig. 1**
under Options

Only fix first component

Click OK  in the Property Manager. This will place Battery origin at the assembly origin and fix the position so Battery cannot move. This fixed component should have a **(f)** before its name in the Feature Manager

▶  (f) BATTERY<1>.

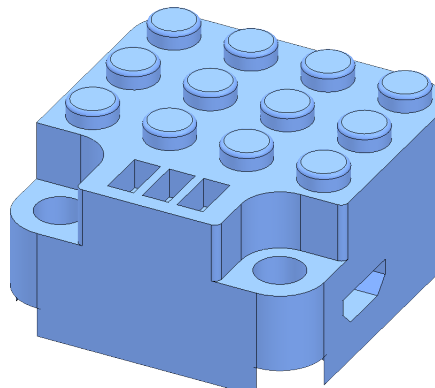

Fig. 2

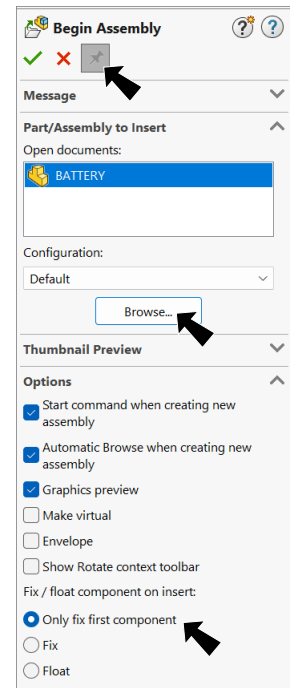

Fig. 1

Step 4. Click **Browse**  in the Property Manager, **Fig. 1**.

Step 5. **Ctrl** click your **TERMINAL** file and click Open.

Step 6. Back in the Begin Assembly Property Manager:
under Part/Assembly in Insert, **Fig. 3**
select **TERMINAL** to highlight it.

Step 7. Place the Terminal, **Fig. 4**.

Step 8. Click OK  in the Property Manager.

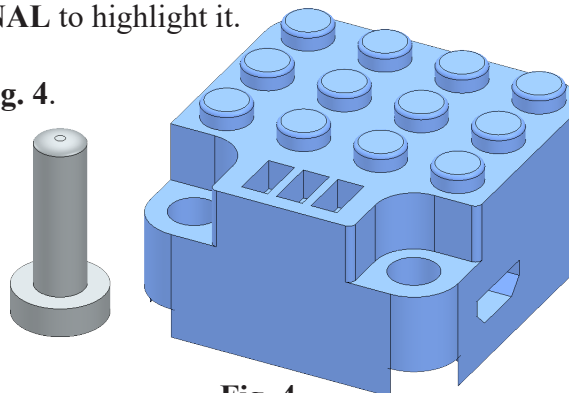

Fig. 4

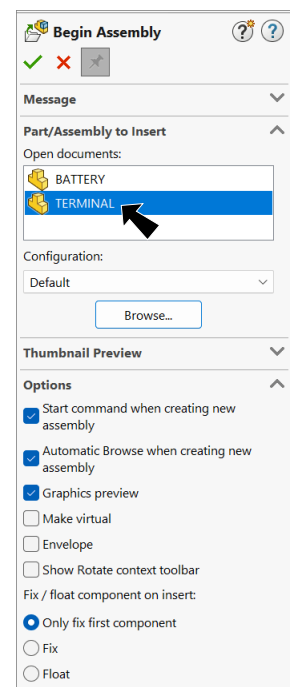



Fig. 3

B. Save as "BATTERY ASSEMBLY".



Step 1. Click File Menu > Save As.

Step 2. Key-in **BATTERY ASSEMBLY** for the filename and press ENTER.

C. Mate: Terminal.

Step 1. Click **Mate**  on the Assembly toolbar.

Step 2. Click a **cylindrical face of Terminal** and **cylindrical face of hole in Battery**, Fig. 5.

Step 3. Click Add/Finish Mate  to add **Concentric**  mate.

Step 4. Click **top face of Extrude1 on Terminal** and **hide side face of Battery**, click **bottom face of hole in Battery**, Fig. 6. To hide face, hover cursor over face and press **Alt** key.

Step 5. Click Add/Finish Mate  to add **Coincident**  mate.

Step 6. Click OK  in the Property Manager.

Step 7. Save  (Ctrl-S).

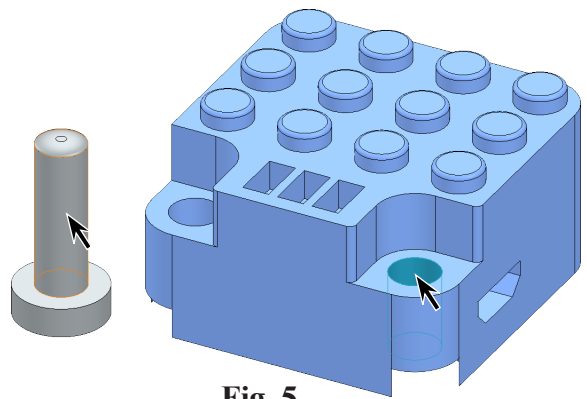

Fig. 5

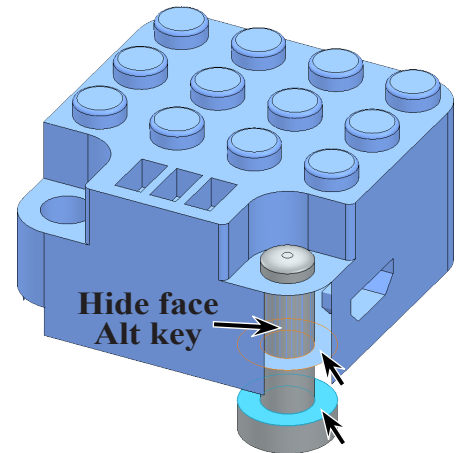

Fig. 6

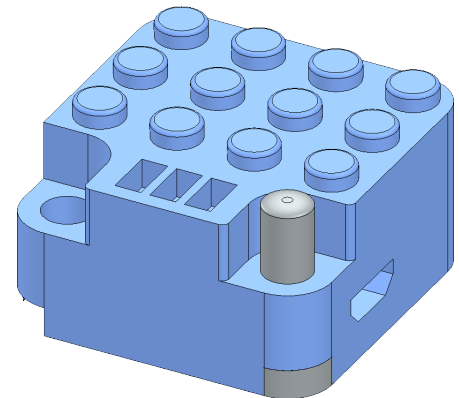



Fig. 7

D. Mirror Terminal Right Plane.

Step 1. **Ctrl click Right Plane**  and **Terminal**  component in the Feature Manager to select plane and component, **Fig. 8**.

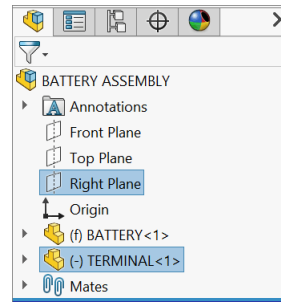

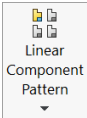

Fig. 8

Step 2. Click **Mirror Components**  in the **Linear Component Pattern flyout**  on the Assembly toolbar.

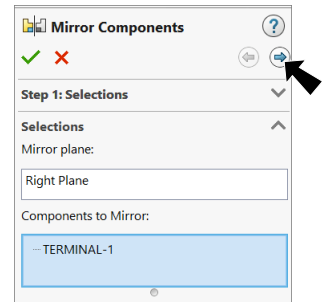



Fig. 9

Step 3. In the Mirror Property Manager: Step 1: Selections all were preselected click **Next**  **Fig. 9**.

Step 4. In the Mirror Components Property Manager click **OK** .

Step 5. Save  (**Ctrl-S**).

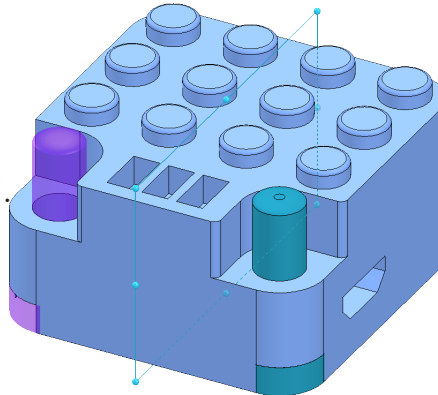

Fig. 11

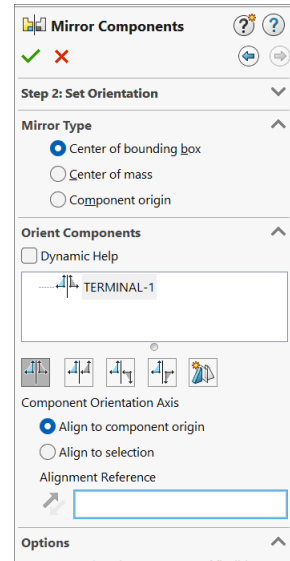

Fig. 10

E. Insert Battery Cover.

Step 1. Click **Insert Components**  on the Assembly toolbar.

Step 2. Select your **Battery Cover** file and Open.

Step 3. Click to place **Battery Cover**, **Fig. 12**.

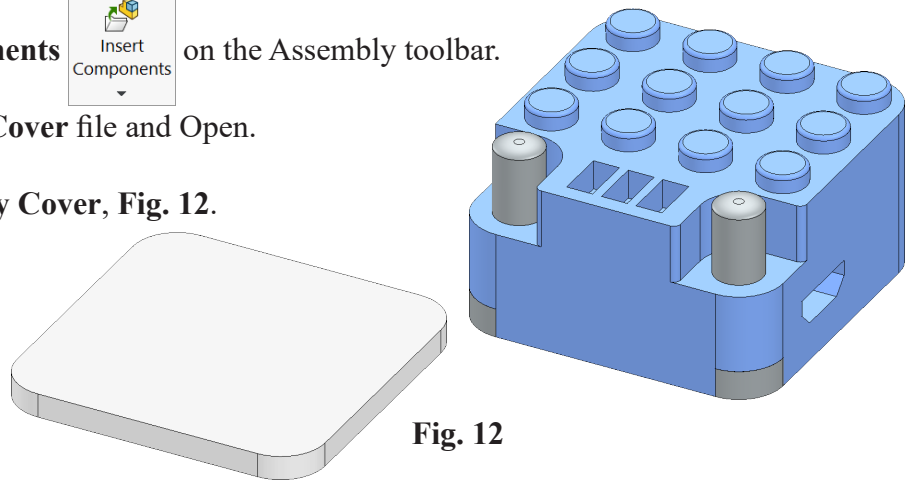

Fig. 12

F. Mate: Battery Cover.

Step 1. Show **Sketch1** of the **Battery** component. To show, expand **Battery** component in the Feature Manager, expand **Boss-Extrude1** and click **Sketch1**, then **Show** on the context toolbar, **Fig. 13**.

Step 2. Click **Mate** on the Assembly toolbar.

Step 3. In the Mate Property Manager: click **Advanced** tab under Mate Types

click **Profile Center** under Mate Selections
 click **top face of Battery Cover** and **Sketch1 of Battery**, **Fig. 15**
 click **OK**.

Step 4. Click **OK** in the Property Manager.

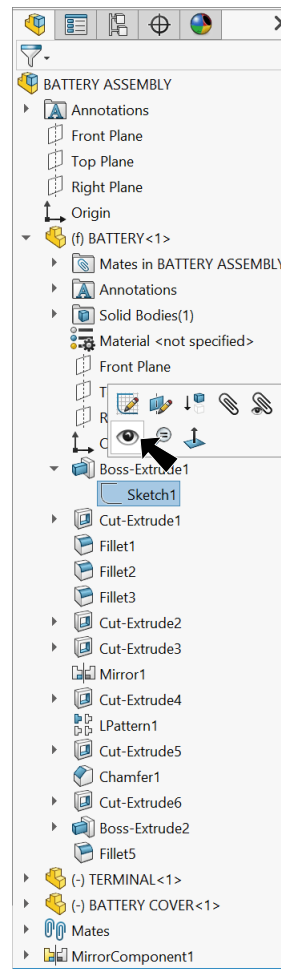

Fig. 13

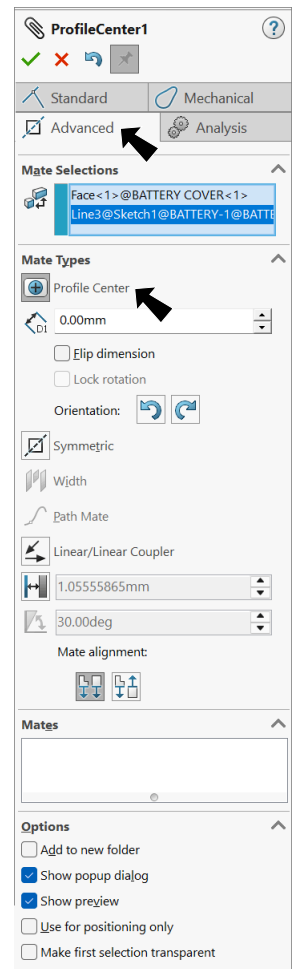

Fig. 14

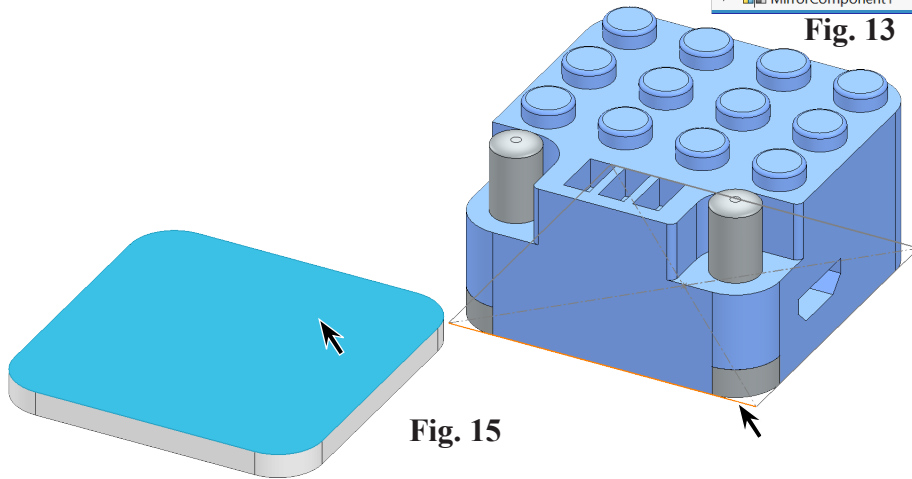

Fig. 15

Step 5. **Hide Sketch1**. To hide, click **Sketch1** in the graphics area and **Hide** on the context toolbar, **Fig. 16**.

Step 6. Save (Ctrl-S).

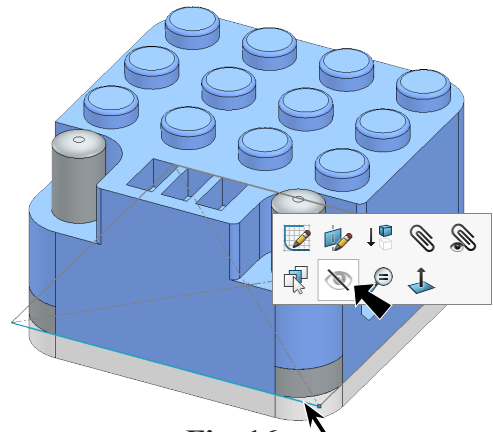

Fig. 16